

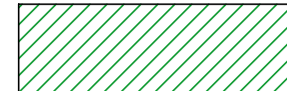





LEGENDA

-  Fascia verde di rispetto
-  Varco visivo
-  Fascia di soccorso
-  Superficie pavimentata
-  Superficie coperta
-  distribuzione dell'ombreggio
-  eventuale area per giochi sulla sabbia

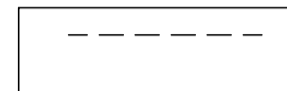
PARAMETRI URBANISTICI

SUPERFICIE COPERTA	SUPERFICIE PAVIMENTATA	BARRIERA VISIVA
ATTREZZATURA DI SPIAGGIA		
20 % max 250 mq	20 % max 250 mq	max 25 %
SERVIZI MINIMI		
5 % max 25 mq	15 % max 100 mq	max 25 %

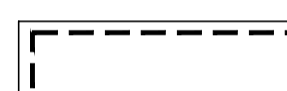
SCHEMA TIPOLOGICO N°1

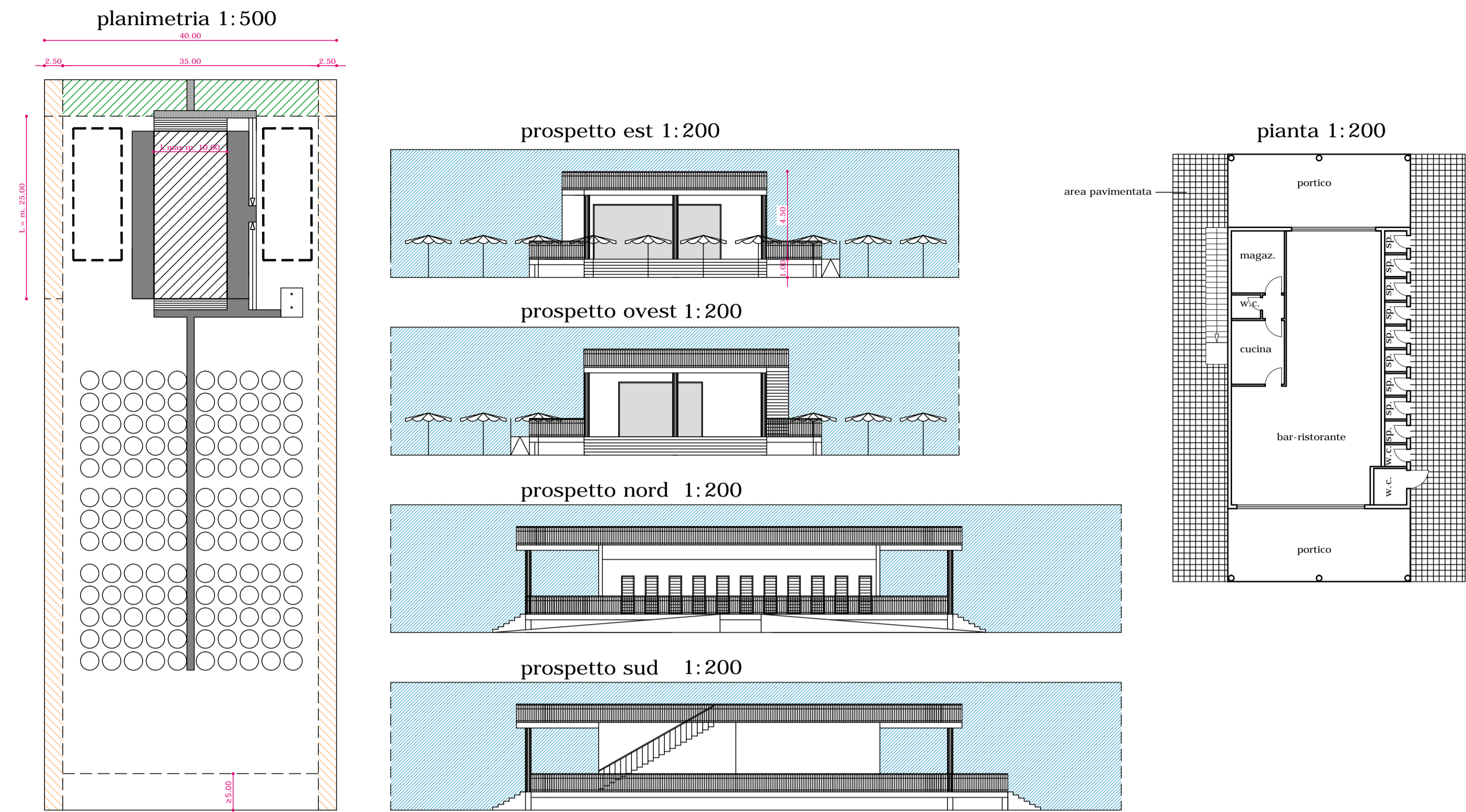

SCHEMA TIPOLOGICO N°2

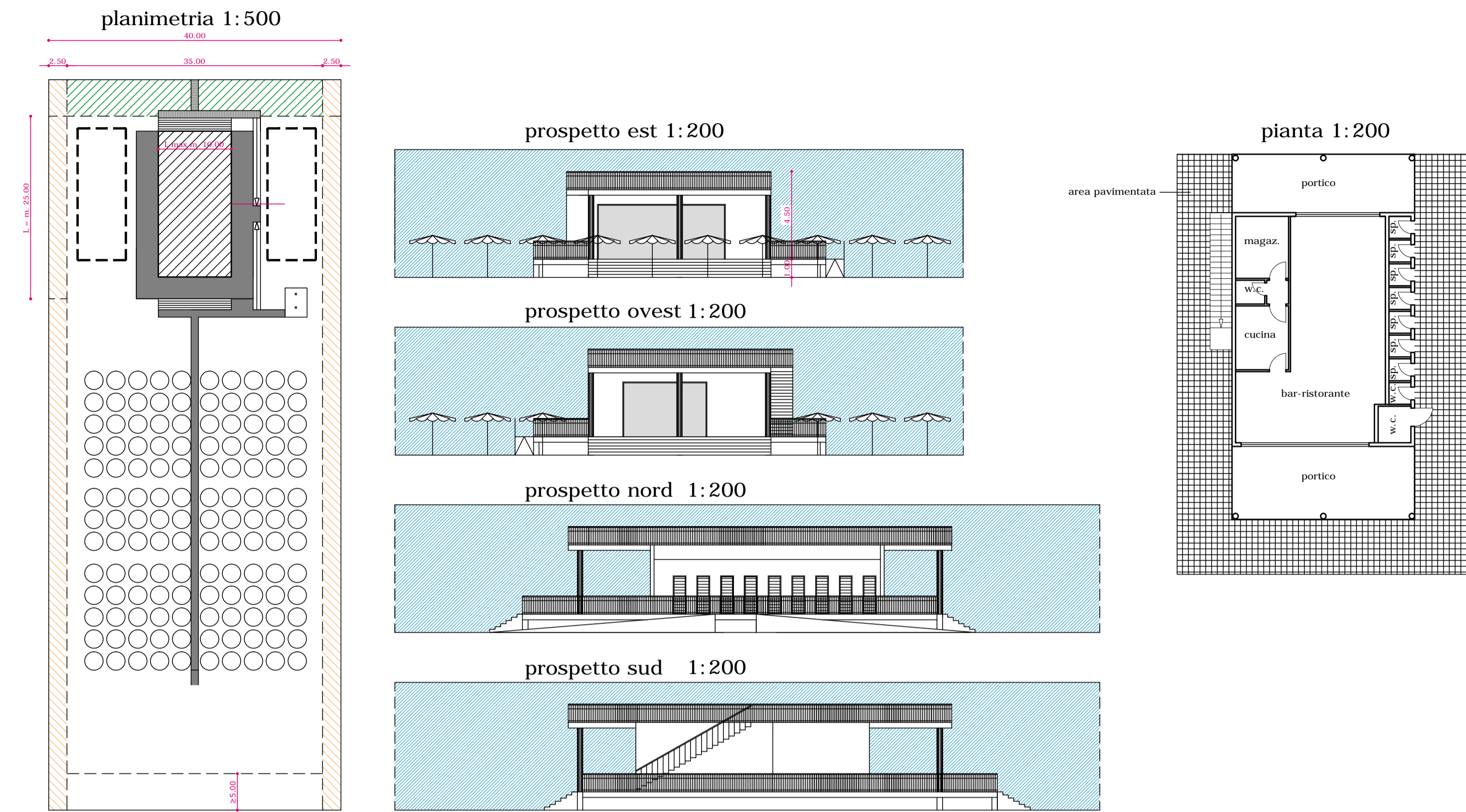

SCHEMA TIPOLOGICO N°3

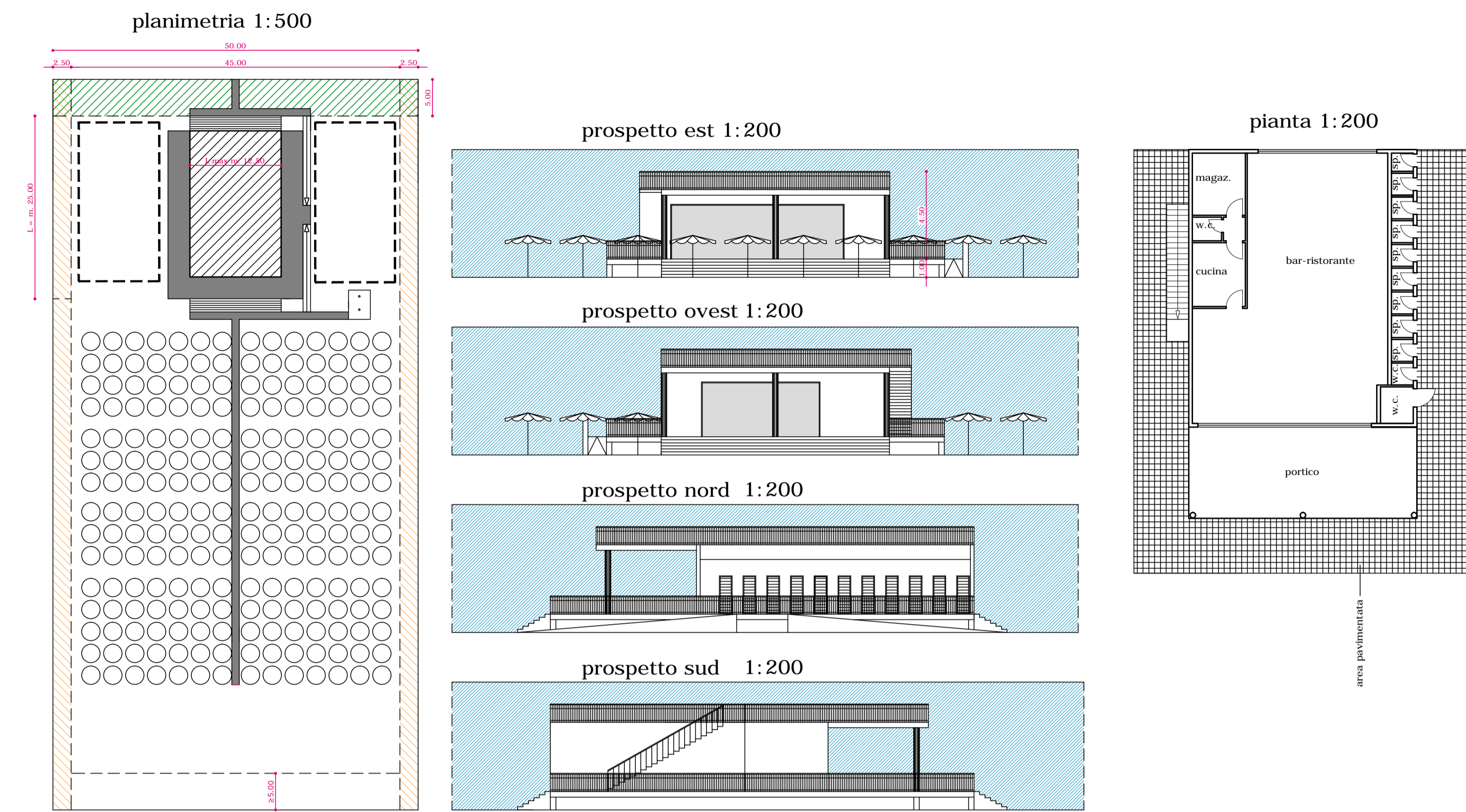

SCHEMA TIPOLOGICO N°4 (solo ombreggio)

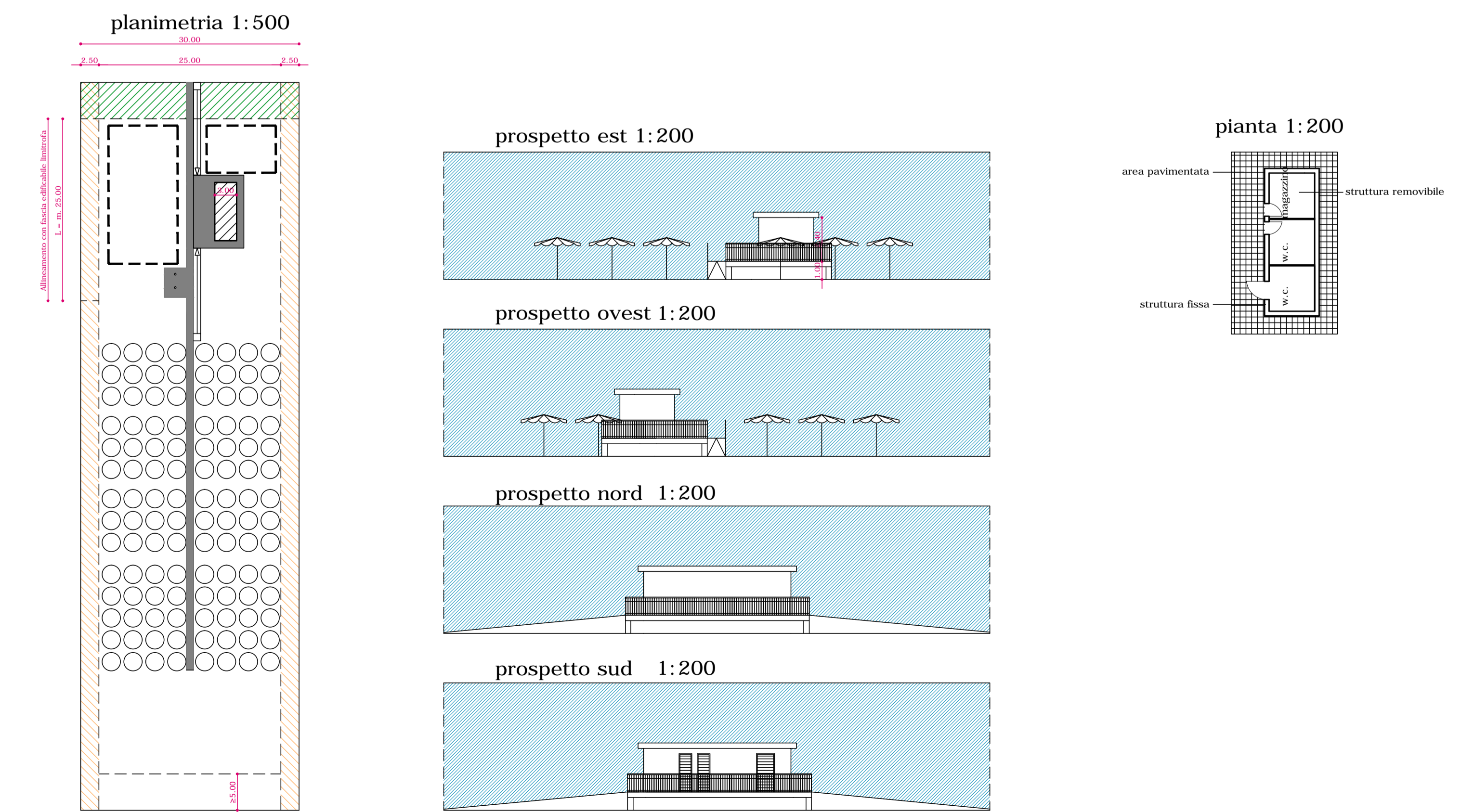

SCHEMA TIPOLOGICO N°5 (spiagge libere)

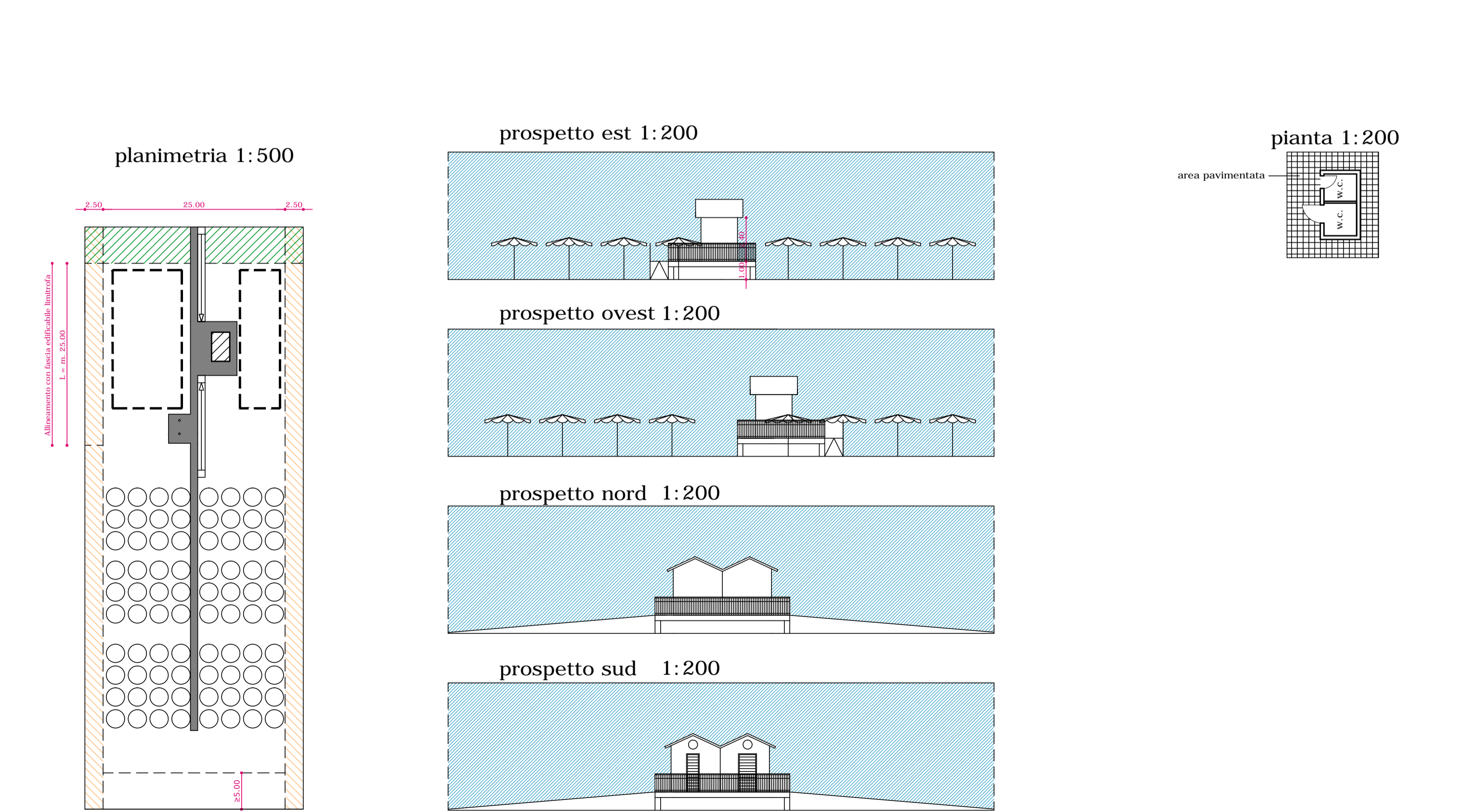

SCHEMA TIPOLOGICO N°6

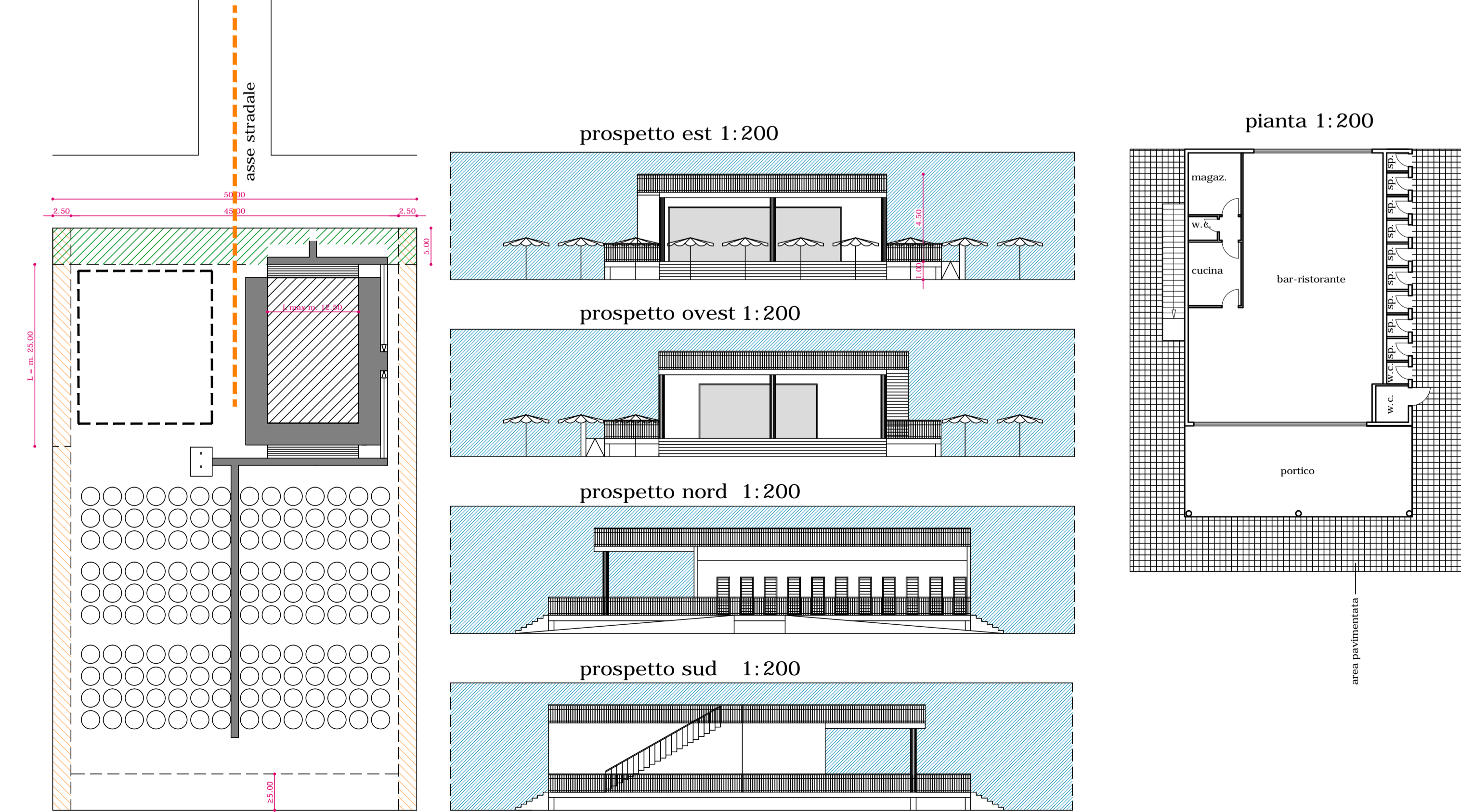



CITTA' DI ROSETO DEGLI ABRUZZI
PROVINCIA DI TERAMO

NUOVO PIANO DEMANIALE COMUNALE
L.R. 17.12.1997, n° 141 - D.C.R. 29.07.2004, n° 141/1 nel t.v.

TAVOLA N°: **9a** ELABORATO: **Tipologie edilizie**

Elaborato adeguato alla delibera di approvazione del Consiglio Comunale n° 23 del 05-06-2014

PROGETTISTI:
IL DIRIGENTE DEL IV SETTORE: Arch. Lorenzo PATACCHINI

SCALA: 1:500-1:200